

# Window Cleaning Robot ( Manual )



Before using product, please read carefully.

## ROBOT

### ◎ Important safety precautions

Before using the product, please read carefully

- Please observe the instruction and warning related to the product
- Please keep this manual properly
- Do not place the product outdoors, in direct sunlight, high temperature, humidity and water
- Do not put this product together with oil, combustible gas and ignitable coating
- Product operating temperature: 0°C~40°C (32°F~104°F)
- Storage temperature: -10°C~50°C (14°F~122°F)
- Do not let children operate the product

### ◎ Warn

- Be sure to fasten the safety rope before use, and tie the safety rope to the fixed objects in the house to avoid danger.
- Please check whether the safety rope is damaged and whether the knot is loose before use
- The machine must always be connected to the power cord in order to work properly
- For the glass doors and windows without balcony, a danger warning area must be set on the ground below to prevent people from approaching.
- Please fully charge the built-in battery (green light on) before use
- Please do not use it in rainy or humid weather. The surface of the glass is not clean due to moisture
- Please turn on the power before placing the machine
- When placing the machine on the glass, please make sure that the machine can be adsorbed on the glass.
- Please remove the machine and turn off the power
- Do not use on frameless glass
- Be sure to apply the cleaning cloth to the suction cup of the machine to avoid air leakage.
- Remove the obstacles on the glass. Do not use on cracked glass
- When using in reflective glass and coated glass, be careful to scratch the surface of glass due to wind and sand
- Only use pure water or original factory special detergent diluted with pure water. Please do not add any other detergent to the water tank
- After use, please remove the liquid from the water tank before putting it away
- Do not touch the ultrasonic nozzle.

## ROBOT

### ◎ About ROBOT

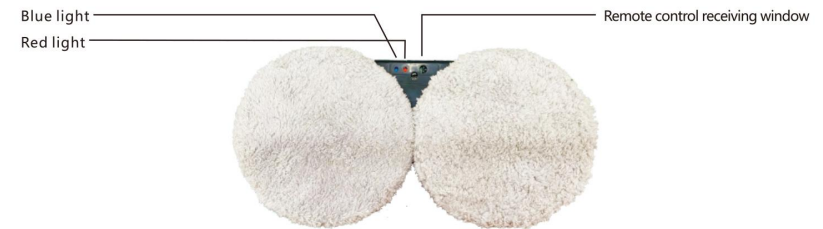

### ◎ How to clean the glass well

#### 1. Dry wipe first

- The first time to wipe, you must "dry wipe" (turn off the water spraying function and do not spray any water), first remove the sand on the glass surface.
- If you spray some water (detergent) on the cleaning cloth or glass first, the water (detergent) will mix with the sand and become yellow mud water, and the wiping result will be very poor
- When using robot in clear or low temperature weather, dry rubbing effect is the best
- Do not use in rainy or humid weather, there will be white fog like traces of moisture

※In case of slipping, spray water on the cleaning cloth※

#### 2. After Wet wipe

- Replace the clean cloth, turn on the water spraying function, or keep the upper cleaning wheel clean and dry explosion. Spray a little detergent (1 ~ 2 spray) on the lower cleaning wheel. Do not wet the whole cloth. The whole wet cloth will affect the operation of the machine.

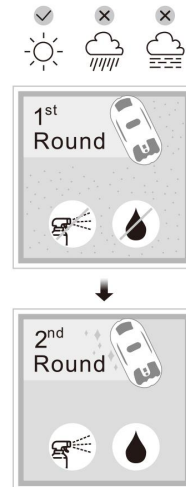

## ROBOT

### 1. Connect the power supply

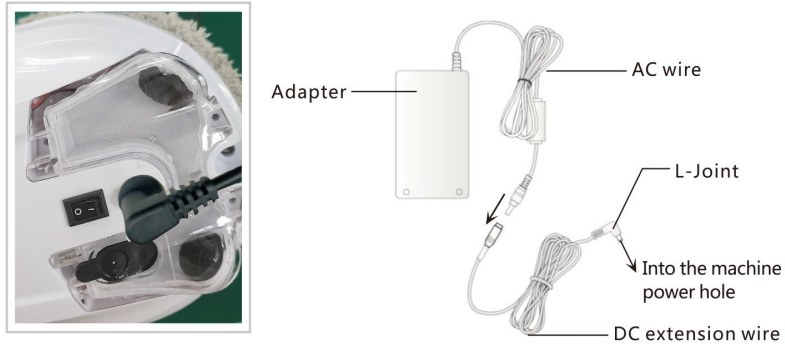

- (1) Connect the DC extension cable to the adapter
- (2) Connect the AC power cord to the adapter
- (3) Insert the L-shaped plug into the power interface of the fuselage and screw it tightly
- (4) Plug the power cord into the socket

### 2. Charging

The machine has internal battery, which is a standby power supply for power failure. Before using, please make sure that the battery is fully charged, and the green light is on.

- (1) Turn off the power switch on the machine first, and after connecting the power cord, the orange light is on, indicating that it is in the charging state.
- (2) When the green light is on, it indicates that the battery is fully charged

### 3. Install the cleaning cloth and ring

According to the figure, make sure to put the cleaning cloth on the cleaning ring, and then copy the cleaning ring to the cleaning wheel correctly to prevent air leakage

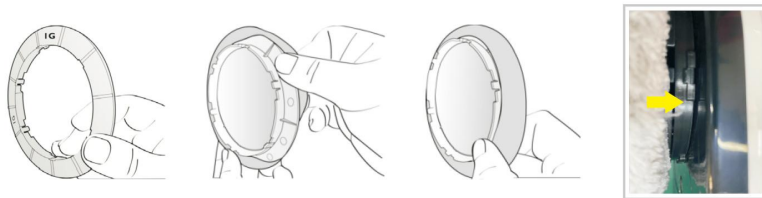

3

## ROBOT

### 4. Safety measures

- (1) For glass doors and windows without balcony, a dangerous dining area must be set on the ground floor, and people are not allowed to approach.
- (2) Before use, please check whether the safety signs are damaged and whether the knots are loose.
- (3) Be sure to fasten the safety rope before use, and tie the safety rope to the fixtures in the house to avoid danger

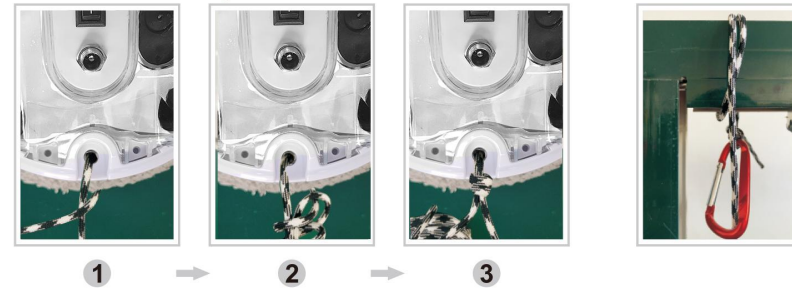

### 5. Full in pure water or diluted original factory special cleaner

Only use pure water or original special detergent diluted with pure water. Please do not add other detergent into the water tank. Fill in to the full waterline (max) as shown in the figure

### 6. Attach the machine to the glass

- (1) First turn on the power of the machine, make sure that the fan rotates
- (2) Put the machine on the glass, and make sure that the well is a certain distance from the window frame
- (3) Make sure that the machine can be adsorbed on the glass, and then let go



### 7. Automatic mode and manual mode

- (1) Select three automatic modes ( ) automatically clean the window
- (2) Press ( ) or ( ) stop the machine
- (3) Press ( ) manual operation machine



4

### 8. Remove the machine from the glass

- (1) Grasp the safety rope and remove the machine with other hand
- (2) Remove the machine to safety area, then turn off the power

## ROBOT

### ◎ Constant power system (UPS) function

- (1)When the power is off, the robot will start the internal battery power. It can last for 20mins.
- (2)When the power is off, the robot will stay in place and not move forward, and give a warning sound and the red/blue light flashes interactively. At this time, the user should take back the machine as soon as possible.In order to avoid power depletion and falling.
- (3)Gently use the safety rope pull back the robot; When pulling the safety rope, it should be as close to the glass as possible to avoid falling.

### ◎ Cleaning and Maintenance

#### 1.Washing instructions for cleaning cloth

- Wash temperature below 40 ° C (104 ° F).
- Don't use bleach.
- Don't use soft essence.
- Don't do drying.
- Don't ironing and pressing.
- Don't dry clean.

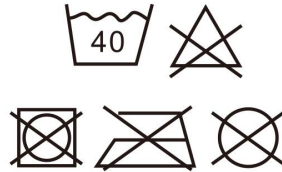

Maintenance frequency: after each use

**Please purchase parts from the original purchaser or local distributor.**

#### 2.Replace the water tank

- (1)As shown in the picture, remove the screws from the water tank with a cross screwdriver .
- (2)Separate the wire from the connecting point. Extract the old water tank along the track.
- (3)Connect the wire of the new water tank. Lock the screws after placing them back along the track.

Maintenance frequency: when the ultrasonic nozzle is blocked

**Please purchase parts from the original purchaser or local distributor.**



#### 3.Replace the ultrasonic nozzle

- (1)Remove the water tank according to the above method.
- (2)Gently pick the upper half of the outer ring of the silica gel ring to remove the ultrasonic nozzle. Don't press the welding joint or touch the ultrasonic plate with your fingers.
- (3)Put the new wave acoustic wave sheet on the water tank, align the connecting line to the right side of the water tank plug, and then gently push the lower half of the outer ring of the silica gel ring into the water tank plug.
- (4)The finger is pressed on one side of the lower half of the outer ring of the silica gel ring, and the other finger is placed on the upper half of the outer ring of the silica gel ring.Gently push the water tank plug.



5

## ROBOT

(5)Check whether the new ultrasonic sheet is glued to the plug of the water tank absolutely.

(6)Connect the wire, put it back to the water tank along the track and lock the screw.

Maintenance frequency: when the ultrasonic nozzle is blocked



**Please purchase parts from the original purchaser or local distributor.**

### ◎ Remote Control

The front and back of the robot can receive the signal from remote control .If you want to change the battery of the remote control, please replace it after pulling down the battery cover below the back of the remote control.

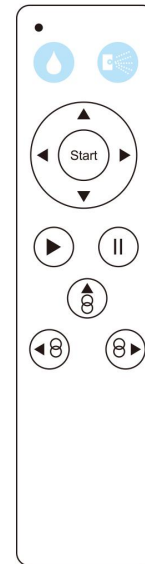

|  |  |
|--|--|
|  | Auto spray water: on/off                         |
|  | Spray water a time                               |
|  | First up, then down automatically clean glass    |
|  | First left, then down automatically clean glass  |
|  | First right, then down automatically clean glass |
|  | Manually move up, down, right and left           |
|  | Stop cleaning                                    |

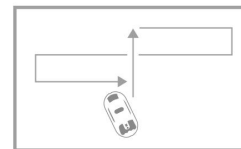

First up, then down automatically clean glass

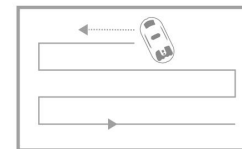

First left, then down automatically clean glass

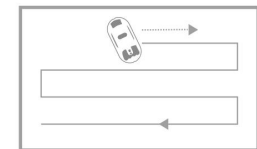

First right, then down automatically clean glass

6

## ROBOT

### ◎ Frequently Asked Question(FAQ)

#### Q1. Lithium-ion battery charging and protection instructions.

Please keep fully charge for the lithium battery before the machine is stored. It should be fully charged every 4-6 months to avoid the overdischarge fault caused by natural discharge of the lithium battery. It can't be fully charged after charging 3-4 hours. The lithium battery needs to be replaced.

#### Q2. The robot stopped working due to power failure. Make a long warning sound, red/blue light twinkle. How to deal with?

(1) Gently use the safety rope pull back to the robot. When pulling the safety rope, it should be as close to the glass as possible to avoid falling.

(2) Turn off the robot's power switch.

(3) Check whether the wire has bad contact or broken.



#### Q3. The robot will test itself at the beginning of working. If it doesn't work smoothly and gives a beep and a blue light blinks, Please check:

(1) Whether the cleaning cloth is too much dirty.

(2) The friction coefficient of glass stickers and fog stickers are relatively low. Not be suitable to use.

(3) When it's very clean to wipe for the glass, the glass will be very slippery.

(4) When the humidity is too low (air conditioning room). After wiping many times, the glass will be very slippery.

(5) (Press  or  or ) When starting the robot. Please place the robot some distance away from the window frame, to avoid errors in the judgment of the robot.

#### Q4. Press the up automatic cleaning mode. The robot failed to detect window upper edge due to skidding:

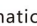
Please press  or use automatic cleaning mode (  or  ).



#### Q5. The robot can't climb upward due to skidding. Possible reasons :

(1) The friction is too small. Stickers, insulation stickers, or fog stickers have a lower coefficient of friction.

(2) The cleaning cloth is too wet.

(3) When it's very clean for the glass. the glass will be very slippery

(4) When the humidity is too low (air conditioning room), the glass will be too slippery after wiping many times.

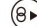
(5) (Press  or  or ) When starting the robot. Please place the robot some distance away from the window frame to avoid errors in the judgment of the machine.

#### Q6. The robot can't clean the whole window completely, and finish the window cleaning operation in advance.

Please press  or  continue cleaning using automatic cleaning mode.

#### Q7. The robot stop working at the border or corner during operation. And emit a beep, red light flashing, how to deal with?

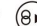
When the border strip is gentle. It is possible to let the cleaning ring climb on the rubber strip when moving and cause rapid air leakage. At this time, the machine will stop wiping due to safety considerations. Please place the robot at some distance from the window frame. Please press  or  automatic cleaning mode to continue cleaning.

## ROBOT

### ◎ Frequently Asked Question(FAQ)

#### Q8. The robot can't move smoothly. Possible reasons:

(1) The cleaning cloth is too dirty, please change a clean cleaning cloth.

(2) There are different zones on the glass surface (glass zone, Sticker Zone, Insulation Sticker Zone or fog Sticker Zone), please use robot in a single area.

(3) The cleaning wheel screw is loose, please lock it tightly.

(4) The cleaning ring fixed buckle fracture, clean and replace the cleaning ring.

#### Q9. The circular wheel marks is remained on the glass surface after cleaning.

The cleaning cloth is too dirty or wet. Please replace a clean cloth and wipe it again.

#### Q10. Wiped glass. Curved traces from night light?

The first wipe, please turn off the spray water function and clean the sand with a clean cloth. The second wipe, please replace a clean cloth. Turn on the spray water function and keep upper cleaning wheel clean and dry. Make lower cleaning wheel spray a little detergent or alcohol (1-2 times), no need all wet, can eliminate arc marks. A completely wet cleaning cloth will affect the operation of the robot.

#### Q11. The robot has cleaned all the glass, but it cannot stop automatically.

Please press (  ) stop working.

#### Q12. The robot won't spray water.

(1) Please confirm whether the water spraying mode has been turned on.

(2) Clean the ultrasonic nozzle with a clean soft cloth.

(3) If NO.1 and NO.2 can't eliminate the condition, please replace the removable water tank.

**If there is a problem with the product and you can't find the solution in the instruction manual. Please contact the original purchaser or local distributor.**